

# Set Up

## 1 PRIME

### PRIME DRUG LUMEN

with straight Heparin until fluid exits all side ports



### CATHETER CONNECTOR

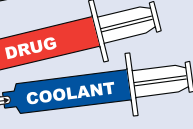

### PRIME COOLANT LUMEN

until fluid exits end hole



## 2 POSITION

### POSITION CATHETER IN PATIENT

(6F or larger sheath and 0.035 Guidewire)

## 3 INSERT

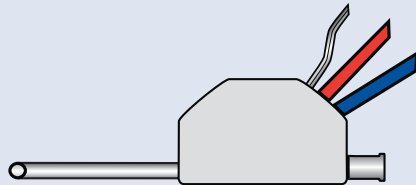

### REPLACE GUIDEWIRE WITH MICROSONIC DEVICE

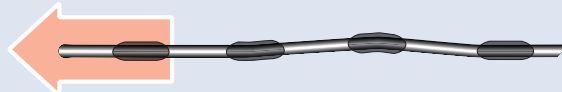

## 4 PUMP

### CONNECT DRUG LUMEN TO INFUSION PUMP

Infuse per hospital protocol  
Max 35 ml/hr  
Min 5 ml/hr

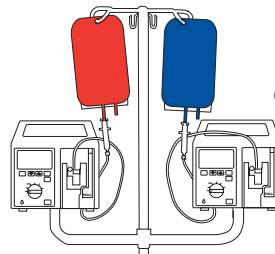

### CONNECT COOLANT LUMEN TO INFUSION PUMP

Infuse per hospital protocol  
Max 150 ml/hr  
Min 35 ml/hr

### TURN ON INFUSION PUMP

## 5 CONNECT

### CONNECT ENDOVASCULAR DEVICE TO CONNECTOR INTERFACE CABLE

Device Connectors

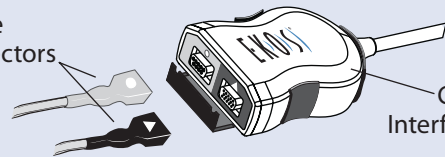

(CIC)  
Connector Interface Cable

## 6 TURN ON

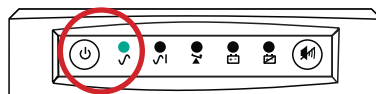

**PRESS AND HOLD BATTERY BUTTON FOR 2 SECONDS UNTIL GREEN LIGHTS APPEAR**

### TURN ON CONTROL UNIT

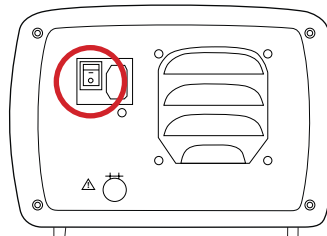

### PRESS START TO ACTIVATE MICROSONIC DEVICE

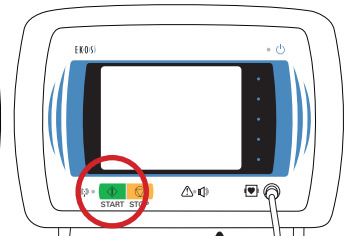

**EKOS Corporation**  
11911 North Creek Parkway S.  
Bothell, WA 98011, USA  
425-415-3100  
888-400-3567  
Fax: 425-415-3101  
www.ekoscorp.com

**For assistance 24/7  
call the EKOS HELP LINE  
888-356-7435**

# Troubleshooting

## CONTROL UNIT ALARMS

**1** Mute ALARM

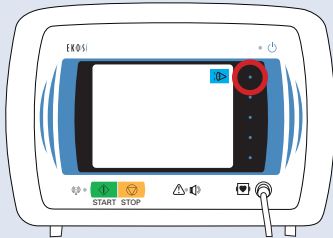

**2** Check Connections

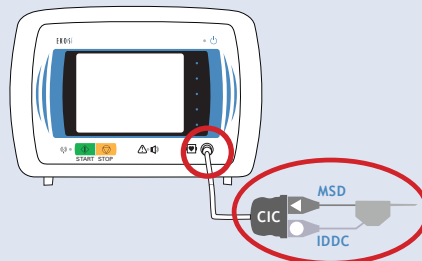

**3** Press **START**

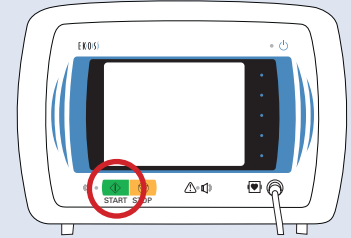

## BATTERY ALARMS

**1** Press **MUTE** button  
for 2 seconds  
Check if battery is plugged in

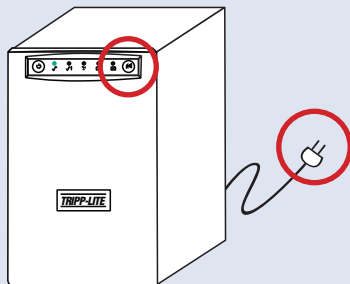

## BATTERY NO POWER

**1** Press and hold battery  
**ON/OFF** button  
Until green light appears on battery

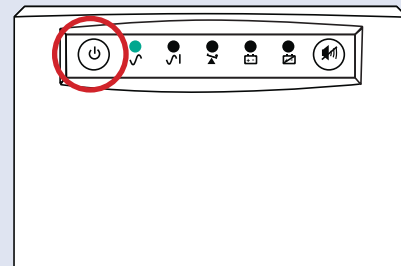

## SYSTEM FAILS TO RESTART

**1** Turn control unit  
**OFF & ON**  
Back of unit

**2** Press  
**START**

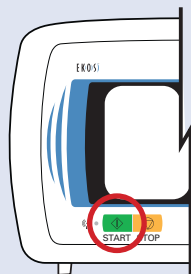
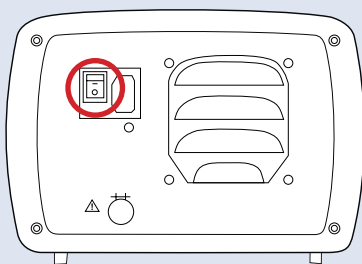

## START PROMPT ALARM

**1** Press **START**  
If needed

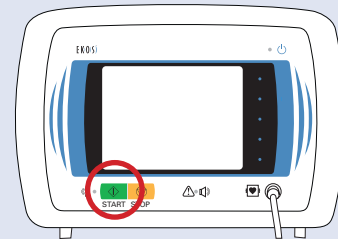

See manual for: • Informational ICON identification  
• Additional trouble shooting

**If you continue to have problems call  
the EKOS HELP LINE for assistance 24/7**

**888-356-7435**



**EKOS Corporation**  
11911 North Creek Parkway S.  
Bothell, WA 98011, USA  
425-415-3100  
888-400-3567  
Fax: 425-415-3101  
www.ekoscorp.com